

Clear Quartz Nozzle Tig Torch & Parts – H2S1 Set for #17, #18 & #26

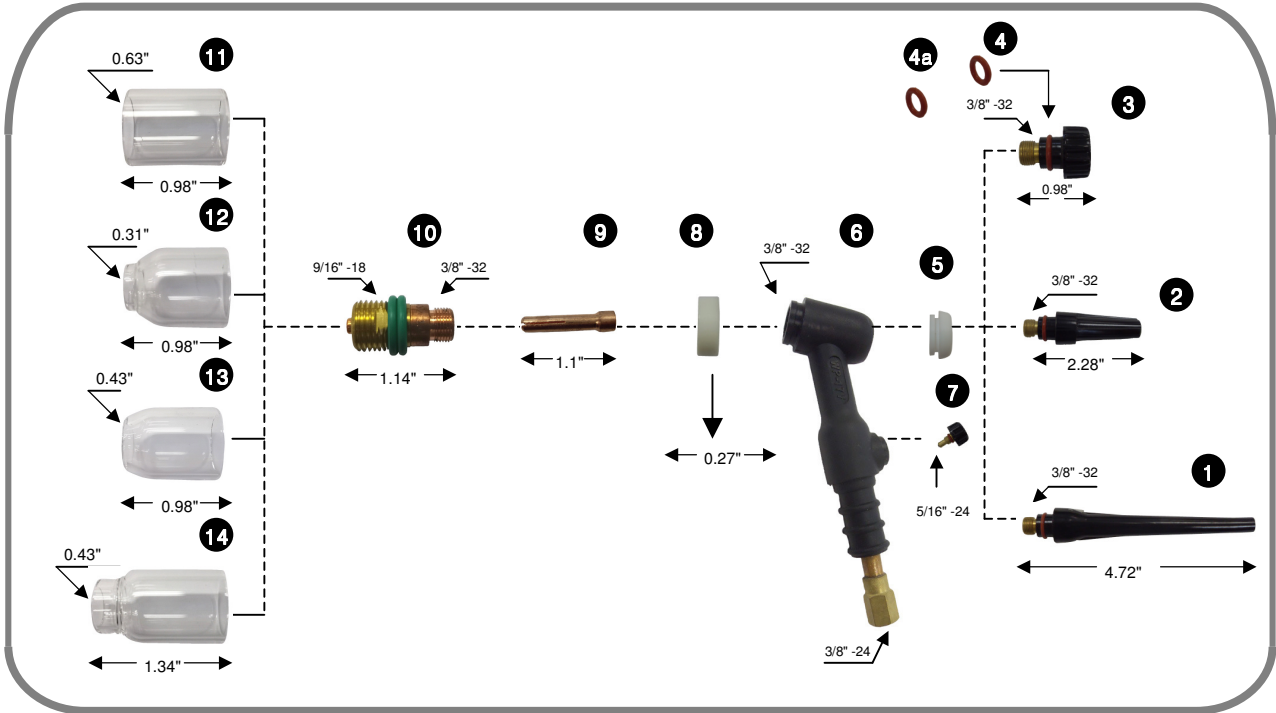

No.	Description	Part No.
1	Back Cap, Long	57Y02
2	Back Cap, Medium	57Y05 (=300M)
3	Back Cap, Short	57Y04
4	O-Ring for 57Y02 & 57Y04	98W18
4a	O-Ring for 57Y05 (=300M)	85W50
5	Back Insulator	18-7
	Torch Body	17
6	Torch Body, w/Valve	17V
	Torch Body, Flexible	17F
	Torch Body, Flexible w/Valve	17FV
	Torch Body	18
	Torch Body, w/Valve	18V
	Torch Body, Flexible	18F
	Torch Body, Flexible w/Valve	18FV
	Torch Body, Straight	18P
	Torch Body	26
	Torch Body, w/Valve	26V
	Torch Body, Flexible	26F
	Torch Body, Flexible w/Valve	26FV
	Torch Body, Straight	26P
7	Valve	VS-2
8	Gasket	H2S1GK17
9	Stubby Collet	See Chart
10	Gas Lens	See Chart

No.	Description	Part No.	I.D. Gas End
11	Quartz Nozzle - Straight	QZ1625-1-16	0.63" (Ø16mm)
12	Quartz Nozzle - Bottleneck	QZ1625-2-8	0.31" (Ø8mm)
	Quartz Nozzle - Conical	QZ1625-C-8	0.31" (Ø8mm)
	Quartz Nozzle - Conical	QZ1625-C-10	0.39" (Ø10mm)
13	Quartz Nozzle - Conical	QZ1625-C-11	0.43" (Ø11mm)
	Quartz Nozzle - Conical	QZ1625-C-12	0.47" (Ø12mm)
	Quartz Nozzle - Straight	QZ1634-1-16	0.63" (Ø16mm)
	Quartz Nozzle - Bottleneck	QZ1634-2-8	0.31" (Ø8mm)
14	Quartz Nozzle - Bottleneck	QZ1634-2-11	0.43" (Ø11mm)
	Quartz Nozzle - Bottleneck	QZ1634-2-12	0.47" (Ø12mm)
	Quartz Nozzle - Conical	QZ1634-C-12	0.47" (Ø12mm)

No.	Description				
	Electrode	.040"	1/16"	3/32"	1/8"
	Diameter	(1.0mm)	(1.6mm)	(2.4mm)	(3.2mm)
	Nozzle Size	#5	#6	#7	#8
Standard Set-Up					
8	Gasket	H2S1GK17			
9	Stubby Collet	10N22S	10N23S	10N24S	10N25S
10	Gas Lens	H2S1GL1.0 (H17GL040)	H2S1GL1.6 (H17GL116)	H2S1GL2.4 (H17GL332)	H2S1GL3.2 (H17GL18)



GRACEDUTY COMPANY LIMITED
 Room 1102 – 1104, 11/F., CRE Centre,
 889 Cheung Sha Wan Road, Kowloon, Hong Kong, China
 Tel: (852) 2420-5808 (6 Lines) Fax: (852) 2420-5507
 E-mail: welding@graceduty.com.hk http://www.graceduty.com.hk